



Year 2 Summer Term Two Homework Project Map Skills



Our homework project this half term is related to our Geography topic. It is an opportunity for children to complete some engaging, hands-on map projects. These ideas focus on building spatial awareness and fundamental map skills.

1. Create a **Shoebox Diorama Map**



Make a **3D model of a "local" area** using a shoebox. You could choose your bedroom or your street. Or you might decide to do Swinton precinct, the local park, woodland or marina. Use craft materials like pipe cleaners, clay, and Lego to build features, and include a simple key (e.g., green felt = park, blue paper = river).

2. Create a **Treasure Map Challenge**

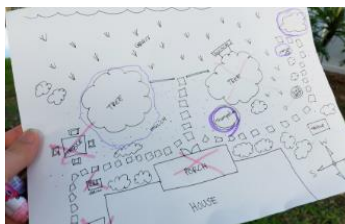

Design an **aged pirate or fantasy treasure map** of your local area, your back garden or even your living room. You should draw physical features (trees, fences, couches) and create a dotted pathway to "x marks the spot," complete with a key and compass rose indicating North, South, East, and West.

3. Create a **My Journey to School Map**



Plan a pictorial bird's-eye view map tracing the route from home to school. Children can draw landmarks they pass - like a specific shop, a red post-box, or a zebra crossing - helping them understand real-world spatial relationships.



I cannot wait to see all of your projects. Please hand them in by Friday 26th June. Thank you.

Or create your own idea as long as it is related to 'Our Local Area' and 'Maps'.

